



BTWJK

Bluetooth Audio module

Kit for lighting switch support



Bluetooth receiver module for stereo audio signals, with integrated 3.5 mm jack input.

Introduction

When turned on, the device LED (white) emits 2 flashes and then goes off.

The device has three operating modes depending on the configuration set: HOME, HIDDEN and HOTEL (default: HOME mode).

NO DEVICE CONNECTED		
Mode	VISIBLE (bluetooth devices in scanning)	CONNECTABLE (already previously paired)
HOME	YES	YES
HIDDEN	On demand (by pressing button, visible for 60s)	YES
HOTEL	On demand (by pressing button, visible for 60s)	On demand (by pressing key, conn. within 60s)
DEVICE CONNECTED		
All	NO	NO

The device is factory configured as follows:

Name: HOME
MONO conversion: disabled
Led brightness: medium
Wi-fi password: disabled
Pairing PIN (*): 0000

(*) Pairing PIN

From firmware 1.1.0 a PIN has been introduced that is necessary for pairing a new device to the module. The default PIN is 0000, from the configuration pages it is possible to customise the PIN with any number consisting of 4 to 8 numeric characters.

HOME mode operation

No device connected

The front LED is off.

The Bluetooth is visible and connectable with the assigned name.

Device connected

The front LED is steady on to indicate the connection, it will go off when disconnected.

The Bluetooth is not visible and / or connectable from other devices.

It is possible to force the disconnection directly from the BTWJK by pressing the button for about 1 second, the LED will turn off and the device will become visible again.

HOME mode configuration

When no device is connected (LED off) it is possible to activate the integrated configuration WI-FI by pressing the button for about 10 seconds until the LED lights up.

When the button is released, the LED will begin to flash intermittently to indicate that it has been activated. Bluetooth is not active at this stage.
See paragraph [Configuration \(WI-FI mode\)](#).

HIDDEN mode operation

No device connected

The front LED is off.

Bluetooth is connectable by devices with which a first pairing has already taken place.

To make it visible (and therefore to make a first pairing), press the button until the LED flashes.

This mode will remain active for a maximum of 1 minute or until a device is connected.

However, it is possible to force the exit from visibility mode by pressing the button again for 1 second.

Device connected

The front LED is lit steadily to indicate the connection, it will turn off when disconnected.

Bluetooth is not visible and/or connectable by other devices.

Force the disconnection directly from the BTWJK by pressing the button for about 1 second, the led will turn off and the device will become connectable again, but not visible.

HIDDEN mode configuration

When no device is connected (led off) it is possible to activate the integrated WIFI configuration by holding down the button for about 10 seconds until the fixed led turns on (while pressing the button the led will flash for temporary activation of Bluetooth visibility).

When the button is released, the LED will start flashing discontinuously to indicate activation.

At this stage, Bluetooth is deactivated.

See paragraph [Configuration \(WI-FI mode\)](#).

HOTEL mode operation

No device connected

If no device is connected, the front led is off, and the Bluetooth is NOT visible and connectable, it is necessary to press the front button for 1 second to activate the Bluetooth.

Once the button is pressed, the LED will flash to indicate the availability of the Bluetooth connection. This mode will remain active for a maximum of 1 minute or until connected to a device. However, it is possible to force exit from visibility mode by pressing the button again for 1 second.

Device connected

The front LED is steady on to indicate the connection, it will turn off when disconnected, the Bluetooth is not visible and / or connectable from other devices.

It is possible to force the disconnection directly from the BTWJK by pressing the button for about 1 second, the LED will turn off and the device will become invisible again pending activation with the button.

HOTEL mode configuration

When no device is connected (LED off) it is possible to activate the integrated configuration WIFI by pressing the button for about 20 seconds until the LED lights up steadily (while pressing the LED will flash for the temporary activation of Bluetooth visibility).

When the button is released, the LED will begin to flash intermittently to indicate the activation of the WI-FI. Bluetooth is not active at this stage.

See paragraph [Configuration \(WI-FI mode\)](#).

Configuration (WI-FI mode)

See paragraph ([HOME](#), [HIDDEN](#) o [HOTEL](#)).

The device creates a network called “Tutondo BTWJK”, it can be with or without a password depending on the present configuration (default: without password).

If there is no connection for more than 1 minute, the device will return to Bluetooth mode.

It is also possible to force the exit from the WI-FI by holding the button down for 1 second, the LED will emit two flashes and the BTWJK returns to normal operation.

To configure:

connect the mobile phone / tablet / PC to “Tutondo BTWJK” network.



NOTE:

- any warnings of lack of internet connection must be ignored.
- it will be necessary to confirm to remain on the network without internet.
- in some recent Android devices it is necessary to wait for a specific icon to appear in the notification bar, otherwise the connection is automatically switched to the last known wi-fi with internet.

When at least one client is connected to the WIFI network, the LED will remain steady on.

When the connection is established via WIFI, open the following link:



You can open your favorite browser and type the number in the address bar:

192.168.4.1

the configuration page will open where you can set:

- Bluetooth name.
- Operating mode (home hidden or hotel).
- MONO output (L and R outputs will be the mixing of the L and R channels of the Bluetooth audio stream).
- LED brightness.
- Possible password of the configuration WI-FI network.

The current firmware number will also be shown at the bottom right.

The screenshot shows a web interface for configuring a device named 'Tutondo - BTWJK'. The interface has a blue header with the device name. Below the header, there are several configuration sections: 'Bluetooth Name:' with a text input field containing 'Tutondo BTWJK'; 'PIN:' with a text input field containing '0000' and a note '4 to 8 numbers'; 'Operating mode:' with a dropdown menu set to 'Normal mode (always visible and connectable)'; 'BT audio channels mono conversion:' with an unchecked checkbox; 'Led luminosity:' with a horizontal slider bar; and 'Wifi password enable:' with an unchecked checkbox. At the bottom center is a blue 'Save' button. At the bottom right, in a blue box, is the text 'fw: 1.1.0'.

Once the changes have been made, press "Save", a notice of successful saving will appear. Press "Reboot", the device will reboot in normal mode with the new configuration.

Factory configuration reset

- To reset to factory settings:
- - Disconnect the device from the power supply.
- - Press and hold the button.
- - Power up the device.
- - Maintain pressure for 10 seconds until the LED flashes.
- - Release the key, the device has returned to the factory settings.

Firmware update

From the main page click on the box showing the FW number, the link will take you to the next page.

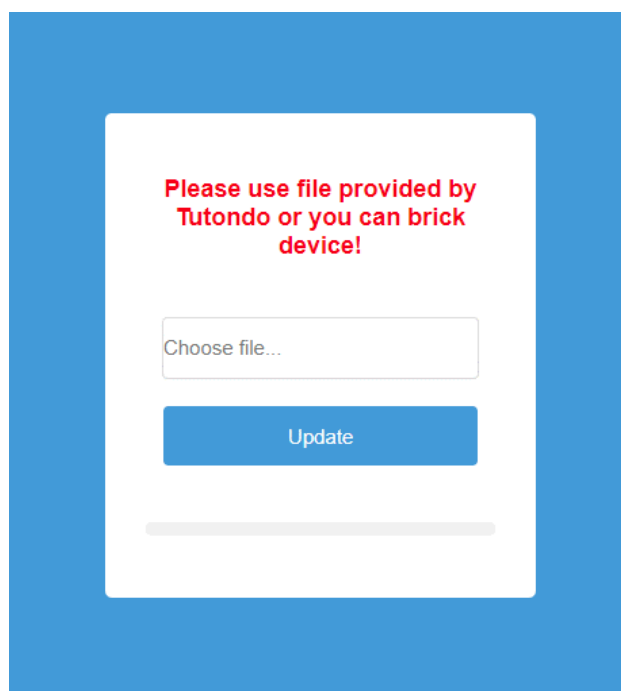

Press "Choose file" and select the update file, then press "Update" and wait until 100% is reached. The progress bar can also freeze for a ten seconds on a number.

Once the update is finished, the LED will turn off and make 2 blinks for starting.



NOTE:

It has been reported that in rare cases some (Android) devices seem not to communicate correctly with BTWJK devices via WIFI. If the progress bar stops for more than a minute on a percentage or if the device led starts blinking again (indicating the loss of WIFI connection with the mobile phone) the update fails.

In this case, the firmware is not compromised but it is necessary to change the device with which it is updated.

To cancel the WIFI session (led steady on) simply press the button, the led will turn off and the WIFI mode can be restarted as described in the previous paragraphs.

BTWJK devices are constantly being updated to maximise any present and future incompatibilities.

PROBLEMS

PROBLEM	SOLUTION
When updating FW the bar hangs	See note to paragraph firmware update try with another device
I cannot adjust the volume in Windows 10 Volume goes from 0 to 100%	This is a problem known to Microsoft with some devices, you need to disable the absolute bluetooth volume. See related paragraph
I cannot correctly adjust the audio volume on my Android device	In the Android device, go into the BTWJK device's Bluetooth settings and deactivate the "Absolute volume" tick.

WINDOWS ABSOLUTE VOLUME DISABLING

It is possible to launch a script that you can find in the download area of the Tutondo website, for the BTWJK product. Alternatively, follow the procedure below:

- - type `cmd` in the search box on the taskbar and press enter.
- - the black command prompt window appears, paste the following command and press enter to execute it.

```
reg add HKLM\SYSTEM\ControlSet001\Control\Bluetooth\Audio\AVRCP\CT /v  
DisableAbsoluteVolume /t REG_DWORD /d 1 /f
```
- Reboot the device.

Should it be necessary to reactivate the disabled function in the future, simply replace the number 1 with 0 in the command line.

Informazioni sullo smaltimento per gli utenti (Direttive RAEE)

Attenzione: Per smaltire il presente dispositivo, non utilizzare il normale bidone della spazzatura!

Le apparecchiature elettriche ed elettroniche usate devono essere gestite a parte e in conformità alla legislazione che richiede il trattamento, il recupero e il riciclaggio adeguato dei suddetti prodotti.

In seguito alle disposizioni attuate dagli Stati membri, i privati residenti nella UE possono conferire gratuitamente le apparecchiature elettriche ed elettroniche usate a centri di raccolta designati* o al rivenditore locale che può ritirare gratuitamente se l'utente acquista un altro prodotto nuovo di tipologia simile.

Se le apparecchiature elettriche o elettroniche usate hanno batterie o accumulatori, l'utente dovrà smaltirli a parte preventivamente in conformità alle disposizioni locali.

Lo smaltimento corretto del presente prodotto contribuirà a garantire che i rifiuti siano sottoposti al trattamento, al recupero e al riciclaggio necessari prevenendone il potenziale impatto negativo sull'ambiente e sulla salute umana, che potrebbe derivare da un'inadeguata gestione dei rifiuti.

Sono previste sanzioni molto elevate nel caso di irregolarità nel rispetto del Decreto Leg.vo 151/05.

** Per maggiori informazioni si prega di contattare l'autorità locale competente.*



Attenzione:

Il dispositivo è contrassegnato da questo simbolo, che segnala di non smaltire le apparecchiature elettriche ed elettroniche insieme ai normali rifiuti domestici. Per tali prodotti è previsto un sistema di raccolta a parte.

Warning!

This product carries the symbol above, indicating that used electrical and electronic products must not be mixed with general household waste. There is a separate collection system for these products.

Information for users: Disposal (RAEE Directive)

Warning! Do not use an ordinary dustbin to dispose of this equipment.

Used electrical and electronic equipment must be treated separately, in accordance with the relative legislation which requires the proper treatment, recovery and recycling of used electrical and electronic equipment. Following the implementation of directives in member states, private households within the EU may return their used electrical and electronic equipment to designated collection facilities free of charge*. Local retailers may also accept used products free of charge if a similar product is purchased from them.

If used electrical or electronic equipment has batteries or accumulators, these must be disposed of separately according to local provisions.

Correct disposal of this product guarantees it undergoes the necessary treatment, recovery and recycling. This prevents any potential negative effects on both the environment and public health which may arise through the inappropriate handling of waste.

** Please contact your local authority for further details.*



TUTONDO

a brand of

A.T.E.C. Srl
Via Nobel, 8
30020 - Noventa di Piave
Venezia - Italy
T +39 0421 65288

COMPANY WITH
QUALITY SYSTEM
CERTIFIED BY DNV GL
= ISO 9001 =

tutondo@tutondo.com
www.tutondo.com

P.IVA / C.F. 02571450275
Cap. Soc. € 80.000,00 i.v.
Reg. Imp. VE 02571450275
Iscri. Trib. VE 37661 REA 225721